

M23 Straight Connector, Panel Mount, Crimp, Coupling screw/nut

Male

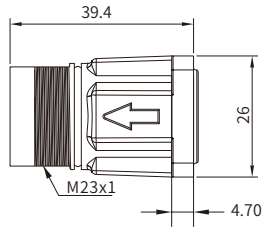

Female

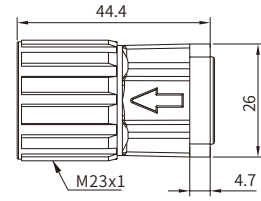

Specifications

Contacts	6(5+PE)	8(4+3+PE)
Certification	ECBT2(ECBT8).E473386	
Pin layout(Male)		
Pin layout(Female)		
Connector insert	PA	
Connector contacts	Brass with gold plated	
Coupling nut/screw	Zinc alloy with nickel plated	
Connector body	Zinc alloy with nickel plated	
Seal / O-ring	FKM or NBR	
Mating Endurance	>800	
Insulation resistance	≥1000MΩ	
Contact resistance	≤5mΩ	
Ambient temperature	-40°C ~ +125°C	
Shielding	Unavailable	
IP rating	IP68 in locked condition	
Cable OD range	2.0~16	
Assembly Instruction	Refer to page 479~470	
Number of positions	6(5+PE)	8(4+3+PE)
Contacts	5+PE	4 3 PE
Contact OD(mm)	2.0(0.25~4.0mm ²)	1.0(0.08~1.0mm ²) 2.0(0.25~4.0mm ²)
Rated current @ 20°C(A)	30	9 30
Rated Voltage(V)	630	250 630
Impulse voltage(V)	6000	4000 6000
Overvoltage category	II	
Pollution Degree	III	

Part Number

Pins	Cable length	Male		Female	
		UL1007	UL1015	UL1007	UL1015
6(5+PE)	0.3m	M23-PSPSTFF306A- I 03	M23-PSPSTFF306A- II 03	M23-PNSSTFF306A- I 03	M23-PNSSTFF306A- II 03
8(4+3+PE)	0.3m	M23-PSPSTFF308A- I 03	M23-PSPSTFF308A- II 03	M23-PNSSTFF308A- I 03	M23-PNSSTFF308A- II 03